

# MEADOWS POINT

## LEVEL 00

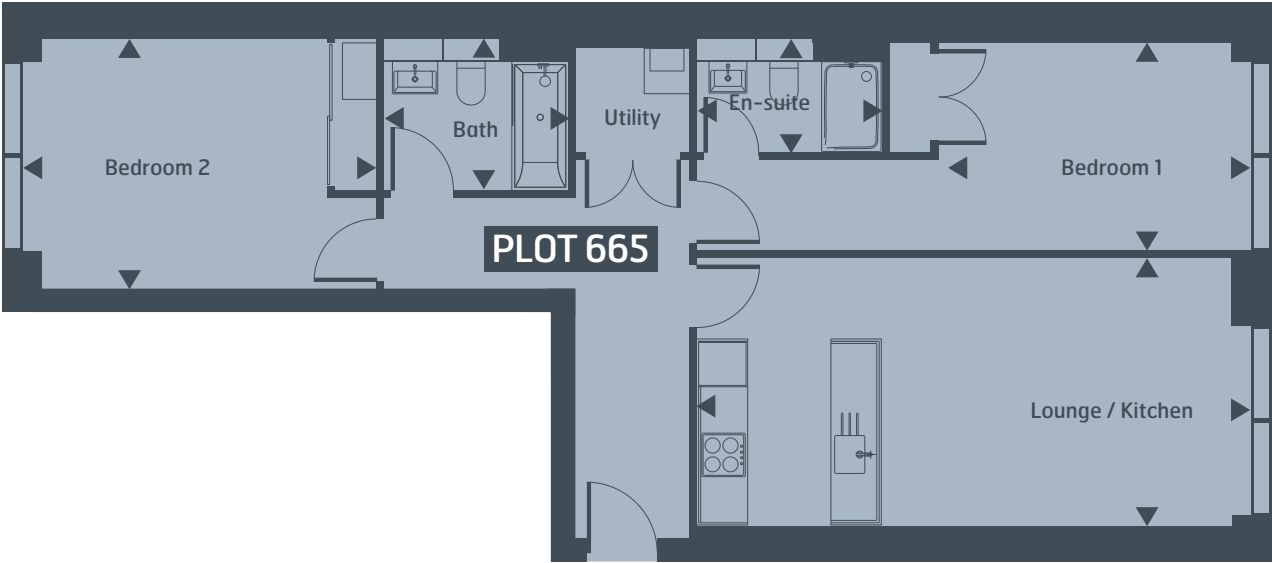

 Common areas

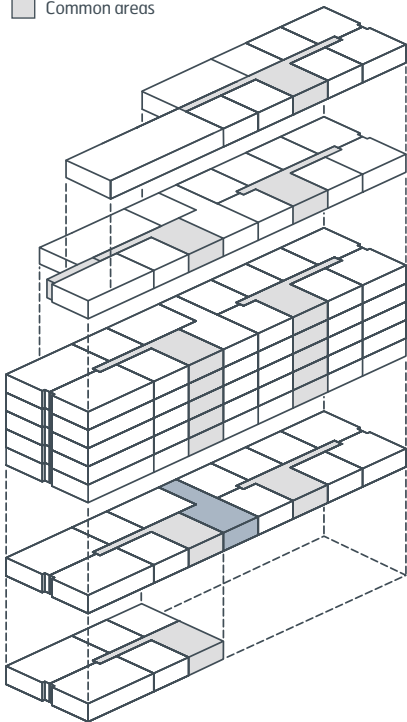

### PLOT 665

#### 2 BED

Plot 665			
868 sqft			
Living/Kitchen	7.080m x 3.580m	23ft 2" x 11ft 8"	
Bedroom 1	3.890m x 2.750m	12ft 9" x 9ft 0"	
En-suite	2.440m x 1.500m	8ft 0" x 4ft 11"	
Bedroom 2	4.430m x 3.300m	14ft 6" x 10ft 9"	
Bathroom	2.440m x 2.000m	8ft 0" x 6ft 6"	

All plans are not drawn to scale and are for illustrative purposes only. Consequently they do not form part of any contract. All kitchen, bathroom and ensuite layouts are provisional and may be subject to alteration.